

### 3 Mounting the motor

**警告** Ensure that the battery is not connected when initially installing or when mounting the motor using the Quick Release Bracket. If not using the motor for extended period or when storing the vessel, disconnect the battery.

#### Installation method

The motor can be bolted directly to the boat OR if using the Quick Release Bracket, bolt the puck to the boat. It is recommended to mount the motor so it is longitudinal with the boat or on a slight angle. This will also depend whether your boat has an electric motor mounting plate. (Fig.4)

### 4 Battery connection

Only use a deep cycle battery of the correct voltage for the motor. Lead acid technology and lithium technology batteries are both suitable. Incorrect battery voltage or connection could damage the motor's electronics.

Connect the battery (+) to the positive (red) terminal, (-) to the negative (black) terminal. The ring connector should always be in the bottom most location with any washer sitting above the ring connector and then the nut. (Fig. 5)

Always make sure that the battery or batteries are secured and free from contact with metal objects to prevent shorting out. A battery box is recommended. Lead acid technology batteries such as AGM may require ventilation.



Always disconnect the motor from the battery when recharging the battery. Failure to do so could damage the motor's electronics.

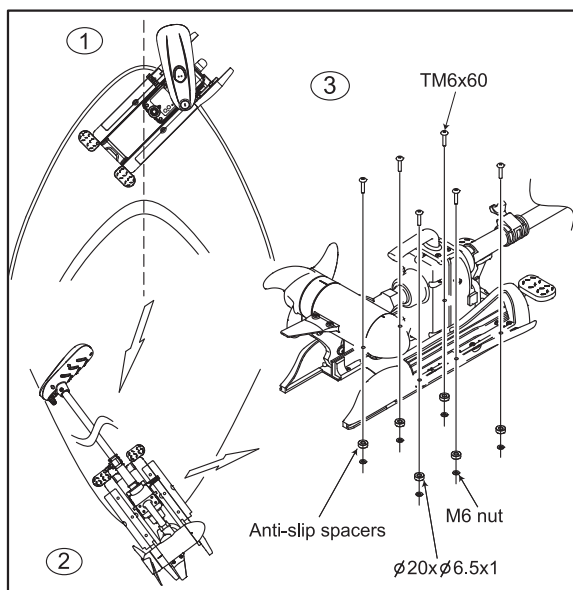

Fig.4

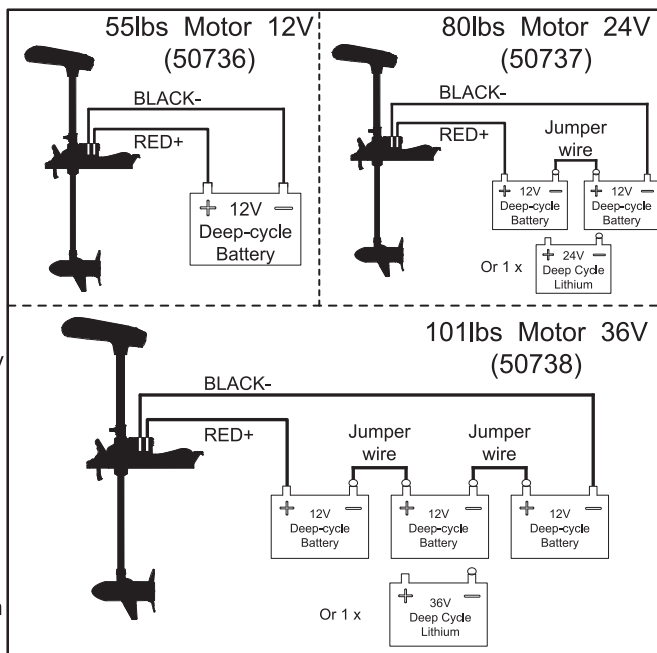

Fig.5